



### At A Glance

- Magnetic on both sides
- Holds ferrous tools in place
- Use to carry tools between locations
- Magnetic attachment to ferrous surface
- Handle for carrying around



### Workshop Tools Range



The Mobile Magnetic Tool Rack is a portable magnetic rack for holding ferrous tools in place. It is also magnetic on both sides so it can be held against ferrous surfaces and then removed and repositioned elsewhere as required without the need to take any tools away to start with.

The Mobile Magnetic Tool Rack has a pivoted handle allowing the user to carry it around safely (and to aid in prising the tool rack away from a ferrous surface it is being held against).

The Mobile Magnetic Tool Rack has two magnetic faces. The reverse side (darker) is the side for magnetic clamping against a ferrous surface (such as a mild steel cabinet) - there is no need to use mechanical fixings such as screws. The front face is also magnetic allowing the user to place ferrous objects such as mild steel tools onto it. Ferrous tools such as spanners, screwdrivers, allen keys, etc can all be held in place.

Since the Mobile Magnetic Tool Rack is magnetic on both sides, it can be removed from the ferrous surface it is put against and transferred over to another ferrous surface elsewhere - you do not have to remove the tools if they are held in place securely. The Mobile Magnetic Tool Rack has a handle on a hinge allowing the user to carry it - the hinge also allows the handle to be pulled away from the ferrous surface to make prising the rack away from the surface for moving elsewhere an easier process.

If you require a Magnetic Knife Rack the Heavy Duty Magnetic Tool Rack is recommended instead.

### Benefits

- Holds ferrous and non-ferrous tools against a ferrous surface
- Portable - with handle for safe movement to another location
- Use as a Magnetic Tool Rack
- Magnetic on both surfaces
- No need for mechanical fixing

### Materials

Magnetic Material	Proprietary Permanent Magnet grade material
Other Parts	Various, including Mild Steel, Plastic

### Performance

Magnetic Performance	Not rated - Magnetic Tool Rack design
Magnet Type	Permanent Magnet Assembly
Temperature Range	-40°C to +80°C (-40°F to +176°F)

### Maintenance

- There is no specific requirement to regularly inspect this item
- Cleaning of surfaces can be achieved using a cloth

### Suitability

Suitable Products	Ferrous tools, Non-Ferrous tools (for gap at back)
Suitable Location	Example - home, office, workshop, kitchen, garage

### Alternatives

- Heavy Duty Magnetic Tool Rack
- Magnetic Trays
- Magnetic Wristband

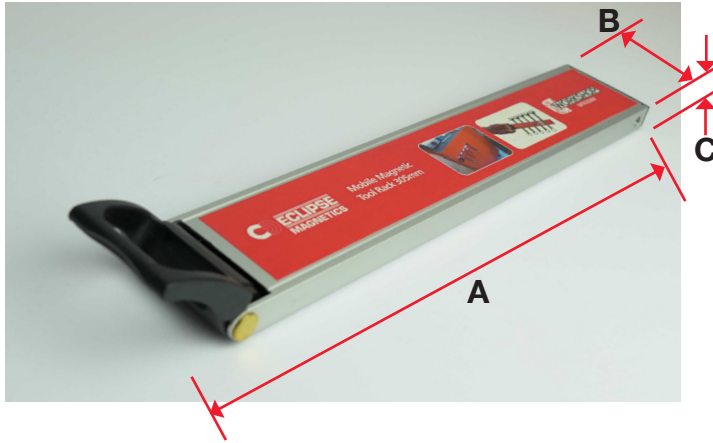

Note:- No tools are supplied with this product.

Product Number	Dimensions (mm)			Weight (kg)	Pull Force* (kg)	Units per Pack
	Overall Length A	Body Width B	Body Height C			
MTR250M	305	50	14	0.57	Not rated	1

\* The Pull Force is not rated because it is designed only for holding various types of material of varying thicknesses, shapes and sizes so the level of hold will depend entirely on the product being held.

For further assistance, please contact [sales@eclipsemagnetics.com](mailto:sales@eclipsemagnetics.com)

Although we have made every attempt to provide accurate information, we do reserve the right to change any of the information in this document without notice.

We cannot accept any responsibility or liability for any errors or problems caused by using any of the information provided.

**Conversions Guide:-**

1kg ≈ 2.204lb ≈ 9.806N

1lb ≈ 0.453kg ≈ 4.448N

1N ≈ 0.101kg ≈ 0.224lb

10mm ≈ 0.393in (≈ 25/64in)

1in ≈ 25.4mm

(the above conversion values are rounded down)



FM 31278 EMS 616377